

Reflective Pods of Pause

"At present we demand from a chair not only that we may sit while resting on it, but moreover that we may become rested quickly while sitting on it. Time is money. Resting thus had to become a specialised field."

- Adolf Loos

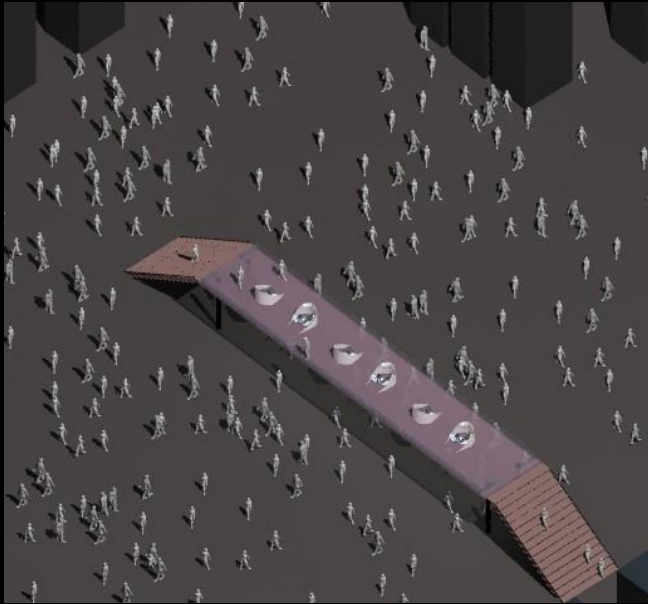

The shape of the pod provides partial interaction with the public without completely isolating its inhabitants from the surrounding world.

In the fast pacing world, a space of calm always grants us a glimpse into ourselves. Within the busy expanse of the urban realm, new ways to perceive the city are always exciting. Known for its dedicated work ethic, Japan has sought new heights in the urban realm. This is balanced by its calm, peace seeking cultural heritage. A modest, elevated resting space with views to the city can act as a centre of attraction, without affecting the activity of the public on the streets. With a span to accommodate a limited scale of seating, walking and standing, the space will act as a buffer and pertain to a slower movement of people. In a country where pedestrian movement has become a defining element of the space, a pause can only add to its charm.



Intimate pods (can also be colloquially referred to as *ipods*)

Reflective Pods of Pause

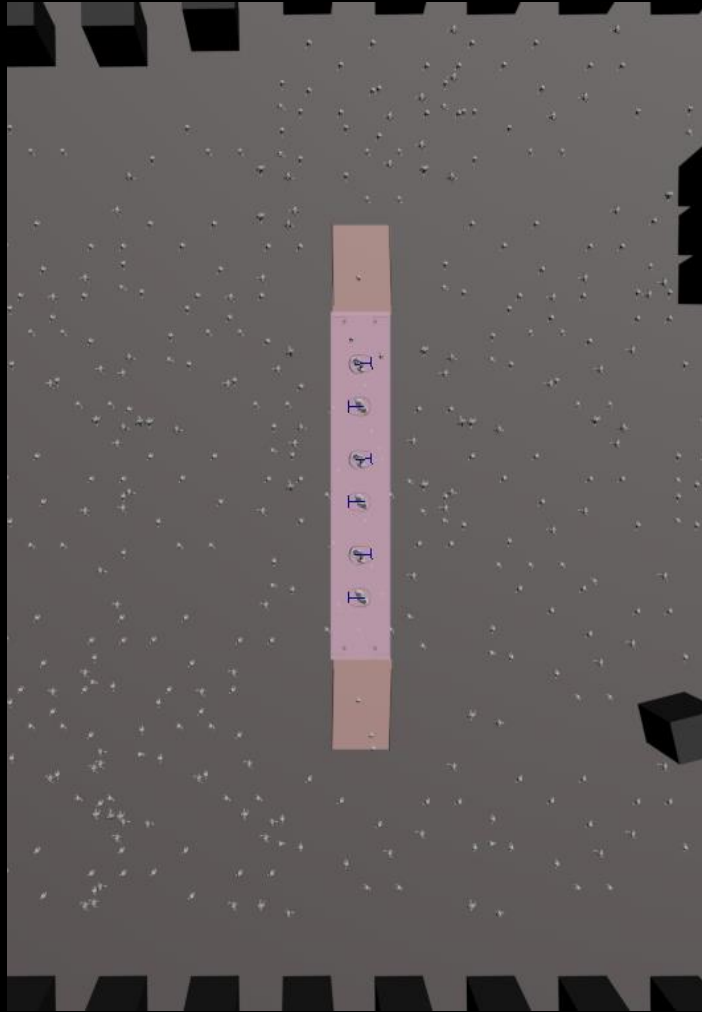

Top view

The space acts as a intermediate pause point within the city. Its colours resonating with the native *Cherry blossoms* of Japan.



The pod, reflective in nature, gives the user a warped perception of themselves and the world. The intimate setting promotes a conducive atmosphere for pausing and interacting amidst the fast pacing world. The seating within is of highest comfort to immediately create a sense of rest and calm.

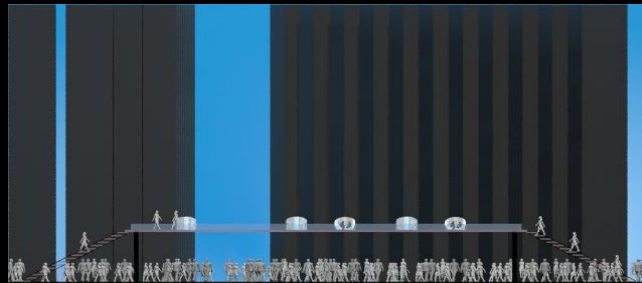

The modest scale of the intermediate space doesn't tamper with the existing skyline of the region. Accessed by a limited number of stairs, the altitude and the existing available space for movement beneath the structure limits the pedestrians from using it as a walkway.



Japan is known for its traditional gateways (*torii*) that mark the transition from the human to holy. As a gentle reminder of the culture, the elevated pausing space acts as a suggestive gateway into the modern realm.