

# BE 1 (+1) FASHION MODEL

## Fashion booth in Ginza

### Fashion model in fashionable street

It's natural that many people are attracted to the life of a model as they are growing up. And many of these people like to have an experience to walk on a catwalk such as a fashion model and this has become their dream. So we decide to help common people to have this experience with the help of **fashion booths**. With this installation, in addition to being a model, people can see their scanned model on the other side, in addition to being a fashion model. With the difference that the scanned model is displayed by color lights, and the colors of the lights can show the status of people. This status can be different items such as health, feeling, the level of activity of individuals that by default, we show here the feeling status of individuals.

← Fashion booth

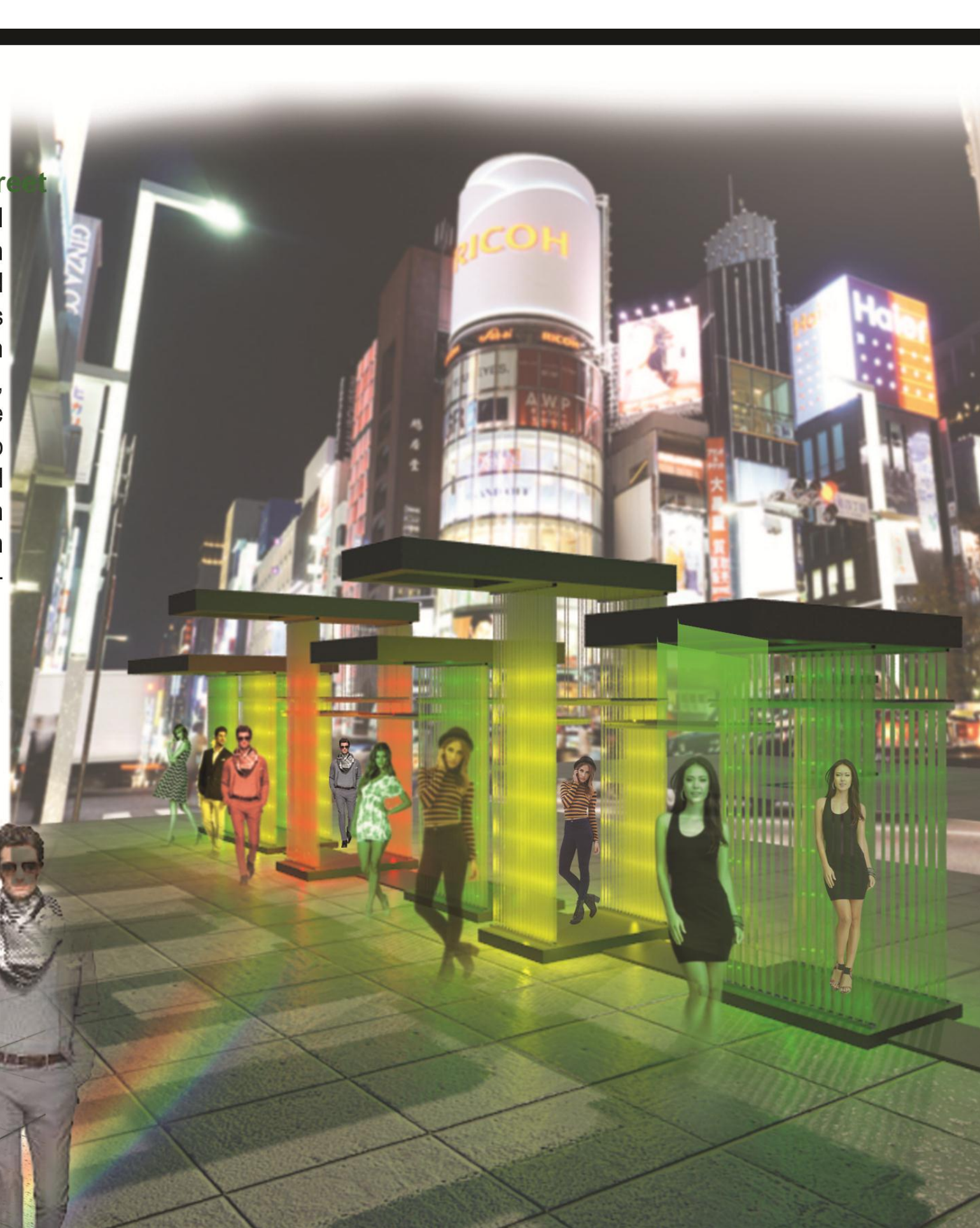

# BE 1 (+1) FASHION MODEL

Fashion booth in Ginza

Fashion model in fashionable street

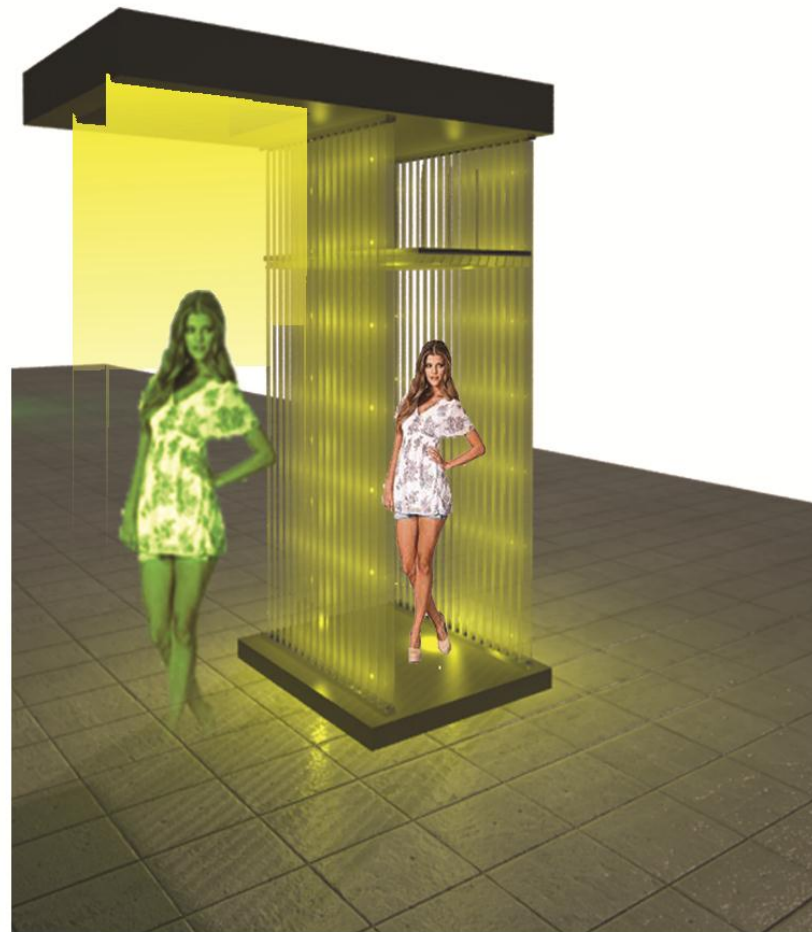
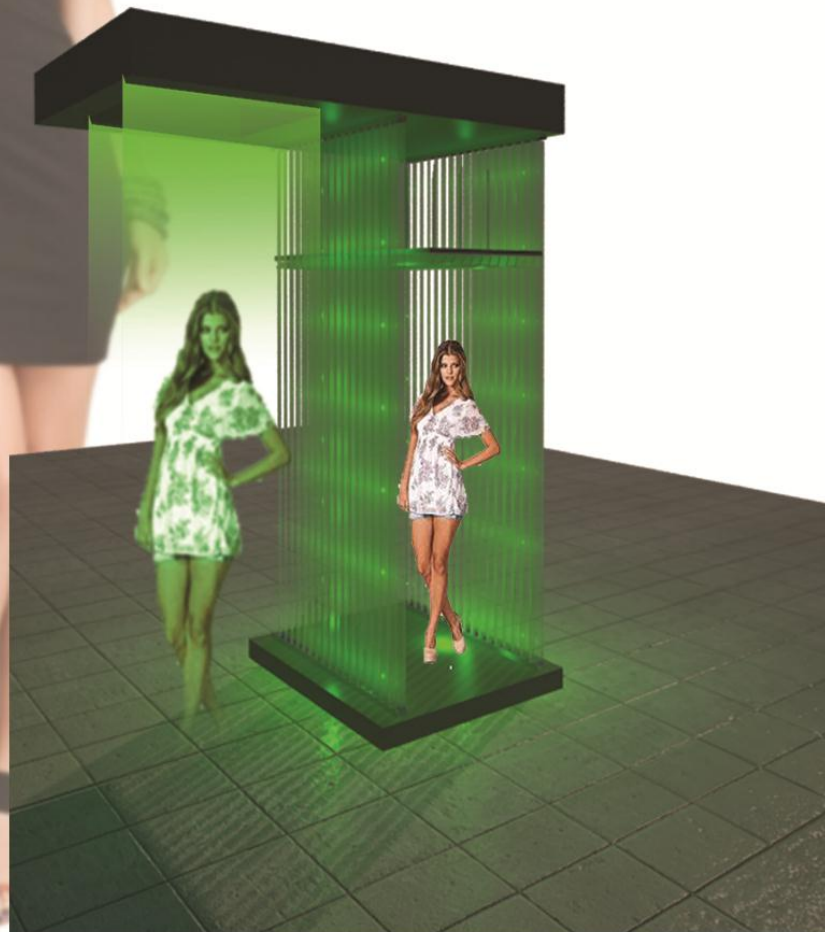

Booths shows citizens feelings 

# BE 1 (+1) FASHION MODEL

## Fashion booth in Ginza

Fashion model in fashionable street



### Dimensions

- Be notice that is our deffult dimension, we can produce diffrent size too.

- The main material for this booth are steel for structue, composite plates for body and glass pieces that reflect the light well for side walls. The mirror ceiling along with the pieces

Our main idea for showing scanned people by color of the lights using scanners that can scan people's feel and showing the result in other side with projection and light. The lower-level recommendation is the use of emotion detection software that is applicable to all smartphones. For example "Mood meter" for showing feeling or "Health" app that show all information about people's activity, health, nutritional facts and etc.



# BE 1 (+1) FASHION MODEL

Fashion booth in Ginza

Fashion model in fashionable street

